



FIXTURE TYPE: _____

PROJECT NAME: _____



- Water temperature between -4°F and 104°F; depth less than 1 meter

GENERAL INFORMATION:

Stylish and durable LED Recessed Pool light crafted from molded SUS 316# stainless steel. Features an 8mm step-tempered glass lens and IP68 waterproof protection for dependable underwater use. With superior heat dissipation and corrosion resistance, it's ideal for pools, fountains, and shallow water installations.

FIXTURE TYPE:

Pool/Fountain Luminaires - Recessed Pool

LIGHTING:

LED

LED

VOLTAGE:

DC 24

MATERIAL:

Hard chromeplated molding shaped stainless steel SUS 316#

LENS:

Step tempered glass. T=8mm

PCB:

Excellent heat conductivity aluminum, coefficient of heat conductivity $\geq 2.0 \text{ w/mk}$

CRI:

80

IP RATING:

IP 68

IP68

IK RATING:

IK 08

sales@gordonbullard.com
www.bullardoutdoor.com
1-877-964-4646



991 South Gull Lake Dr
Richland, MI 49083
USA

FIXTURE TYPE: _____

PROJECT NAME: _____

NOTES:

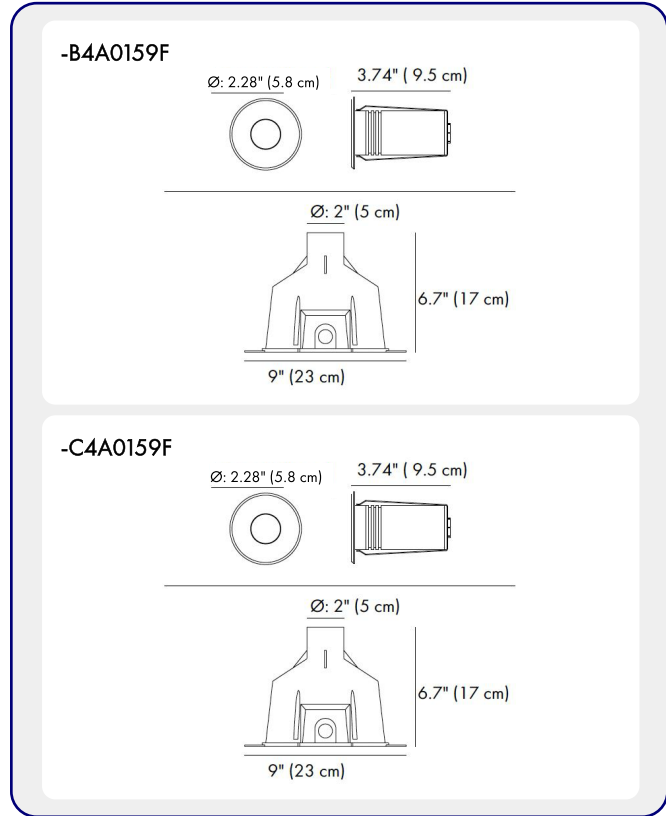

HOW TO ORDER:

CODE:

Example:
CODE: BO-KVN-KPG-PFL-XXX-XXX-XXX-XXX-XXX-XXX

BO-KVN-KPG-PFL-
B4A0159F-B73-30-DIM-
B-120#

1 MODEL:

CODE -B4A0159F

DIMENSIONS:

Diameter - Ø: 2.28" (5.8 cm)
Height - H: 3.74" (9.5 cm)

LIGHT SOURCE:

LED / 1 × 3.6W / 210 mA / 426 lm / DC 24

CODE -C4A0159F

DIMENSIONS:

Diameter - Ø: 2.28" (5.8 cm)
Height - H: 3.74" (9.5 cm)

LIGHT SOURCE:

LED / 1 × 3.6W / 210 mA / 416 lm / DC 24

2 CCT OPTIONS:

-K30 3000K
-CUS Custom on request*

3 BEAM ANGLE:

available only for - B4A0159F model	available only for - B4A0159F model	available only for - C4A0159F model
-B33-9 9°	-B73-30 30°	-C9-45 45°x 35°
-B33-16 16°		
-B33-20 20°		
-B33-45 45°		
-B33-60 60°		

4 DIMMING OPTIONS:

-DIM 1-10V
-PWM Pulse Width Modulation
-DALI DALI (Digital Addressable Lighting Interface)

sales@gordonbullard.com
www.bullardoutdoor.com
1-877-964-4646



991 South Gull Lake Dr
Richland, MI 49083
USA

FIXTURE TYPE: _____

PROJECT NAME: _____

NOTES:



HOW TO ORDER:

CODE:

Example:
 CODE: BO-KVN-KPG-PFL-XXX-XXX-XXX-XXX-XXX-XXX

BO-KVN-KPG-PFL-
 B4A0159F-B73-30-DIM-
 B-120#

5 WATER PROOF SOLUTION: (optional)

- A Water-Stopper(Included)**
 A IP-67 water-stopper is added in the end of luminaires as standard assembly which is also an important system for water resistance.
- B B IP68 Jiffy quick plug/socket connector(Option)**
 A IP-68 connector is as an optional assembly and ensures that water vapor will not enter into luminaires directly.

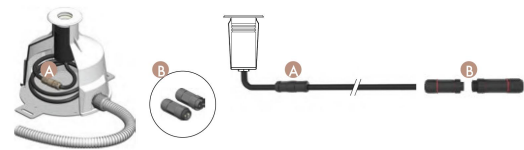

6 SLEEVE: (included)

-120#

Option 1

Mounting Sleeve 120#

-217#

Option 2

Mounting Sleeve 217#

sales@gordonbullard.com
 www.bullardoutdoor.com
 1-877-964-4646



991 South Gull Lake Dr
 Richland, MI 49083
 USA

FIXTURE TYPE: _____

PROJECT NAME: _____

NOTES:



HOW TO ORDER:

CODE:

Example:
 CODE: BO-KVN-KPG-PFL-XXX-XXX-XXX-XXX-XXX-XXX

BO-KVN-KPG-PFL-
 B4A0159F-B73-30-DIM-
 B-120#

7 INSTALLATIONS GUIDANCE:

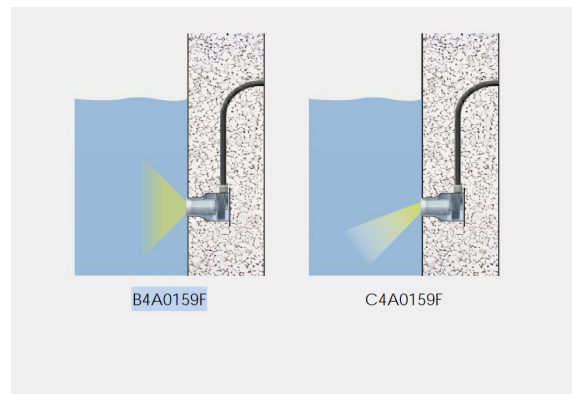
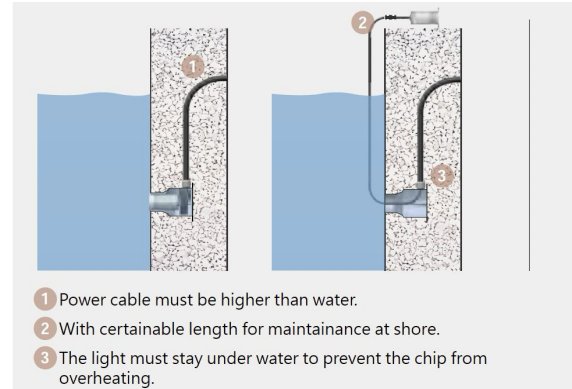

8 PHOTOMETRIC INFO:

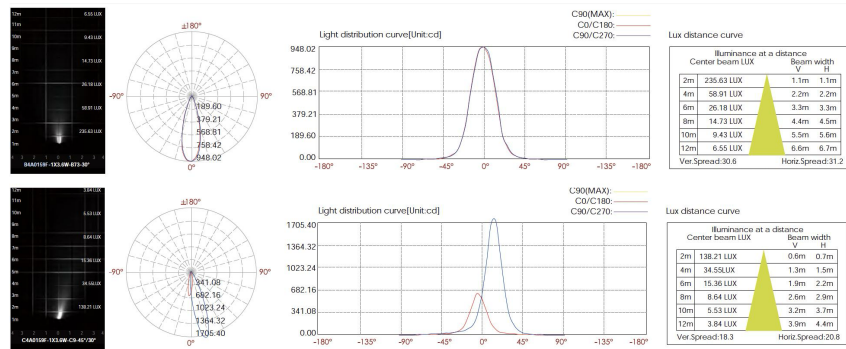

sales@gordonbullard.com
 www.bullardoutdoor.com
 1-877-964-4646



991 South Gull Lake Dr
 Richland, MI 49083
 USA