

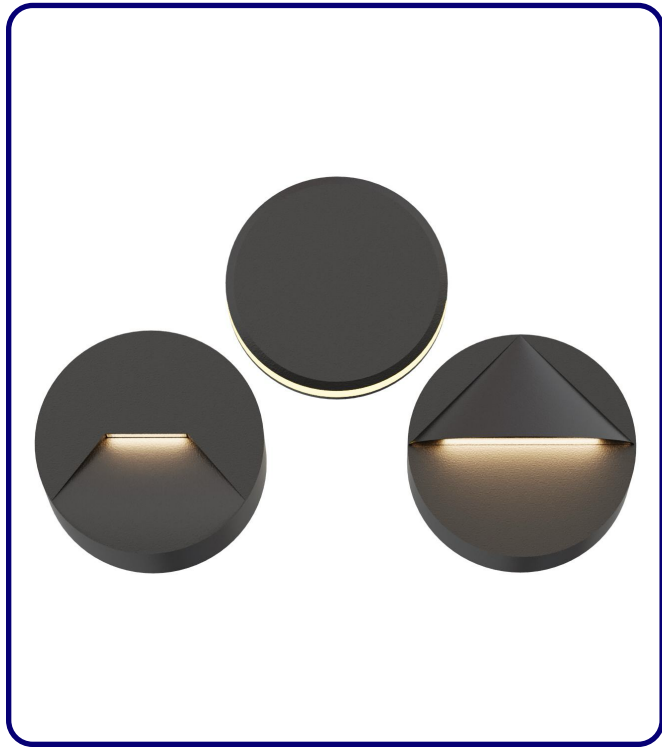

FIXTURE TYPE: \_\_\_\_\_

PROJECT NAME: \_\_\_\_\_



\*CABLE GLAND - IP66

**GENERAL INFORMATION:**

The BENDA Recessed Wall Luminaire is a sleek and durable LED fixture ideal for round and square wall applications. Built from die-cast powder-coated aluminum with a UV-stable, fireproof PC lens, it provides efficient illumination on 110–277V while ensuring lasting performance. With an IP65 weatherproof and IK08/IK09 impact-resistant rating, BENDA withstands demanding environments and supports loads over 2000 kg. Available in Sanded Dark Gray, Sanded Black, and Sanded White finishes, it combines modern design with reliable functionality for stairways, pathways, and architectural lighting.

**FIXTURE TYPE:**

Recessed Wall Luminaires - Round / Square

**LIGHTING:**

LED

LED

**VOLTAGE:**

110-277V

110-277V

**MATERIAL:**

12# Die-casting powder coated aluminum

**LENS:**

UVstop & Fireproof PC T=1 mm

**RECESSED SLEEVE:**

PC/ABS ALLOYS 148#

**LOADING CAPACITY:**

>2000kg

**IP RATING:**

IP 65

IP65

**IK RATING:**

IK 08 / IK 09

**FINISHING:**

Sanded Dark Gray  
Sanded Black  
Sanded White

sales@gordonbullard.com  
www.bullardoutdoor.com  
1-877-964-4646



991 South Gull Lake Dr  
Richland, MI 49083  
USA

FIXTURE TYPE: \_\_\_\_\_

PROJECT NAME: \_\_\_\_\_

NOTES:

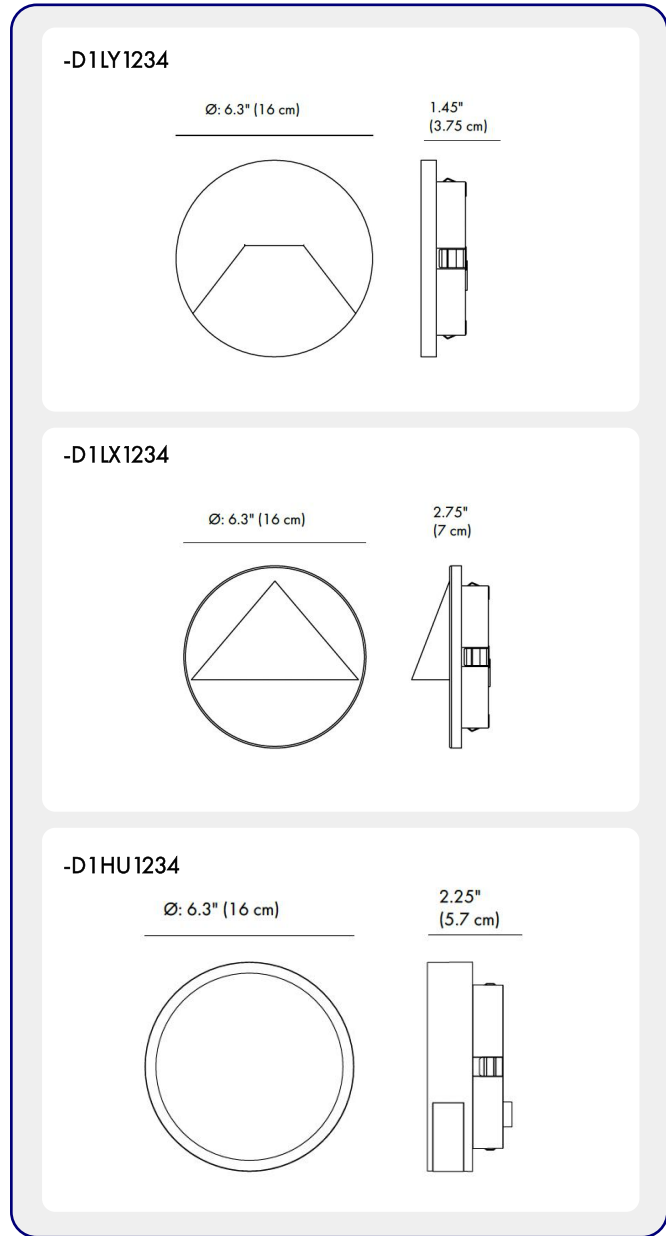

**HOW TO ORDER:**

**CODE:**

Example:  
 CODE: BO-BND-KPG-RWL-XXX-XXX-XXX-XXX-XXX-XX

BO-BND-KPG-RWL-  
 D1LY1234-K30-  
 KAP7037-DIM

**1 MODELS:**

**CODE -D1LY1234**

DIMENSIONS:

Diameter - Ø: 6.3" (16 cm)  
 Depth - P: 1.45" (3.75 cm)

LIGHT SOURCE:

LED / 12 x 0.5W / 250 mA / 134 lm / 110-277V / IK 09

**CODE -D1LX1234**

DIMENSIONS:

Diameter - Ø: 6.3" (16 cm)  
 Depth - P: 2.75" (7 cm)

LIGHT SOURCE:

LED / 12 x 0.5W / 330 mA / 226 lm / 110-277V / IK 08

**CODE -D1HU1234**

DIMENSIONS:

Diameter - Ø: 6.3" (16 cm)  
 Depth - P: 2.25" (5.7 cm)

LIGHT SOURCE:

LED / 12 x 0.5W / 250 mA / 127 lm / 110-277V / IK 08

**2 CCT OPTIONS:**

-K30 3000K  
 -CUS Custom on request\*

**3 FINISH OPTIONS:**

-KAP7037 Sanded Dark Gray  
 -RAL 9005 Sanded Black  
 -RAL9003 Sanded White

**4 DIMMING OPTIONS:**

-DIM 1-10V  
 -PWM Pulse Width Modulation  
 -DALI DALI (Digital Addressable Lighting Interface)

sales@gordonbullard.com  
 www.bullardoutdoor.com  
 1-877-964-4646



991 South Gull Lake Dr  
 Richland, MI 49083  
 USA

FIXTURE TYPE: \_\_\_\_\_

PROJECT NAME: \_\_\_\_\_

NOTES:

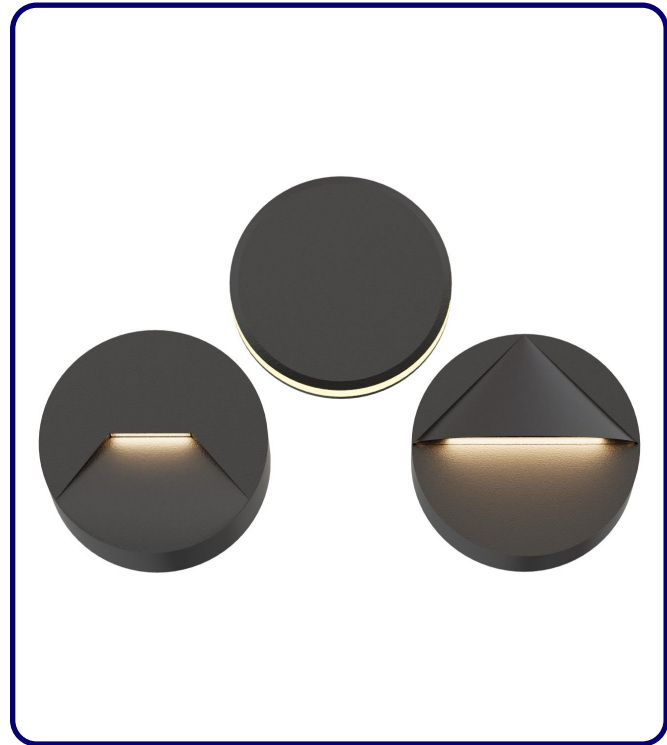

\*CABLE GLAND - IP66

**HOW TO ORDER:**

**CODE:**

Example:  
CODE: BO-BND-KPG-RWL-XXX-XXX-XXX-XXX-XXX-XX

BO-BND-KPG-RWL-  
D1LY1234-K30-  
KAP7037-DIM

**5 RECESSED SLEEVE: (included)**

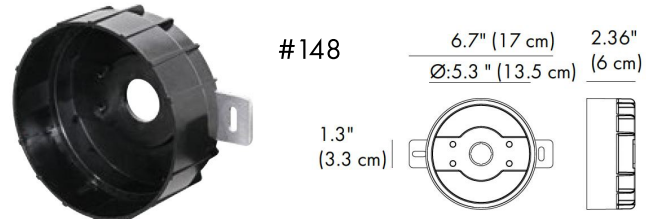

**6 FEATURES:**



Front cover without screws



Use the high-strength clips for installation and fixation. (please refer remark 1 & 2)

**7 DIAGRAM OF INSTRUCTION:**

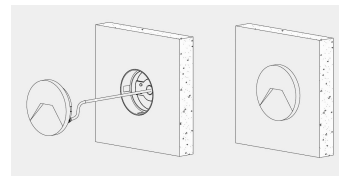

**8 PHOTOMETRIC INFO:**

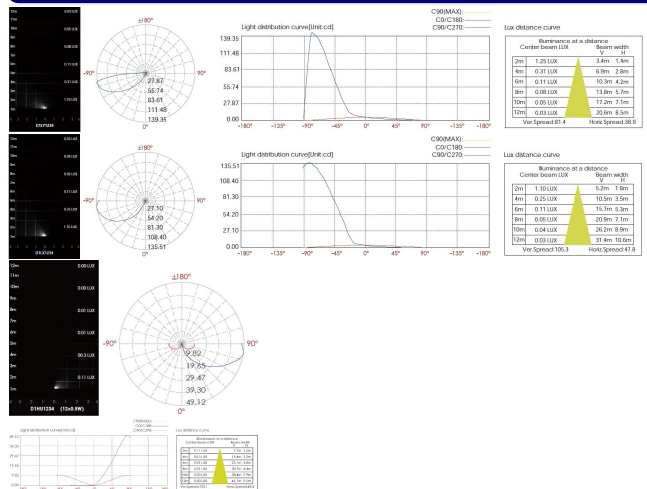

sales@gordonbullard.com  
www.bullardoutdoor.com  
1-877-964-4646



991 South Gull Lake Dr  
Richland, MI 49083  
USA